

QuickSeal Series

Nylon Coil Tubing Dedicated Type

Screw-in type fitting dedicated for nylon coil tubing

Features

- **Screw-in type**
Dedicated use for nylon coil tubing. Consisting of three parts: fitting body, nut and sleeve.



Product number example

S1/4 - M1/4

Thread size
Product number of applicable nylon coil tubing

Applicable tubing

Nylon Coil Tubing



Reference

Instruction manualP.172
Effective sectional areaP.168

Operating fluid, working temperature range

Operating fluid	Working temperature range
Air	-40°C~+100°C

Pressure condition

Maximum working pressure: 1.2MPa
Negative pressure performance:
-101.294kPa

Handling instructions

- ⚠ **Caution:** Dedicated for nylon coil tubing. Cannot be used for connecting other types of tubing.
- ⚠ **Caution:** For use at a high temperature within the working temperature range, tighten the nut periodically. If the nut cannot be tightened further, cut the tubing end and insert the tubing again with a new sleeve.

👉 See page 34 for the common handling instructions for fittings.

Connector



Product number	Applicable nylon coil tubing outer diameter	T Thread size (R)	L (mm)	A (mm)	F Tubing insertion length (mm)	H ₁ Width across flat (mm)	H ₂ Width across flat (mm)	d ₁ (mm)	D ₂ (mm)	Min. inner diameter (mm)	Effective sectional area (mm ²)	Weight (g)
S3/16-M1/8	S3/16	R1/8	115.2	11.0	16	10.0	12.0	5.0	8.5	3.4	8.5	24.0
S1/4-M1/8	S1/4	R1/8	114.3	9.0	18	12.0	14.0	5.4	11.2	5.4	22.0	31.0
S1/4-M1/4	S1/4	R1/4	118.3	12.0	18	14.0	14.0	7.0	11.2	5.4	22.0	36.0
S3/8-M3/8	S3/8	R3/8	120.2	13.0	22	17.0	22.0	9.0	15.6	8.2	50.0	72.0
S1/2-M3/8	S1/2	R3/8	178.5	13.0	29	24.0	27.0	10.2	19.8	10.2	78.0	139.0
S1/2-M1/2	S1/2	R1/2	182.5	17.0	29	24.0	27.0	12.0	19.8	10.2	80.0	160.0
S3/4-M3/4	S3/4	R3/4	—	19.0	31	32.0	35.0	18.0	—	18.0	231.0	—

👉 S3/4 has no spring.

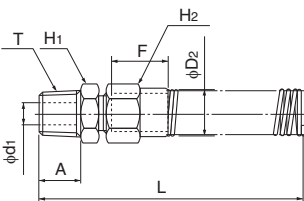

Tubing

Clean tubing

Processed tubing

PushOne fitting

QuickSeal fitting

Clean fitting/ Chemifit

Bamboo-shoot fitting

Control switch/ Detachable series

Jig/Tool/ Accessory

Technical information

Reference

ES swivel nut internal connector



Product number	Applicable nylon coil tubing outer diameter	T Thread size (G)	L (mm)	I (mm)	F Tubing insertion length (mm)	H ₁ Width across flat (mm)	H ₂ Width across flat (mm)	H ₃ Width across flat (mm)	C (mm)	d ₁ (mm)	D ₂ (mm)	Effective sectional area (mm ²)	Weight (g)
S1/4-ES1/4	S1/4	G1/4	123.3	8.5	18	14.0	14.0	19.0	9.0	5.0	11.2	18.5	53.0
S3/8-ES3/8	S3/8	G3/8	129.0	10.0	22	19.0	22.0	22.0	13.0	8.0	15.6	46.5	97.0
S1/2-ES1/2	S1/2	G1/2	189.0	13.0	29	24.0	27.0	27.0	16.0	10.2	19.8	80.0	186.0

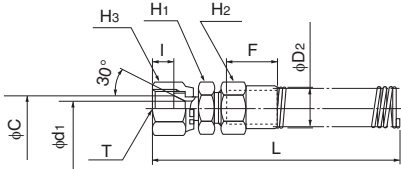

FS swivel nut internal connector



Product number	Applicable nylon coil tubing outer diameter	T Thread size (G)	L (mm)	I (mm)	F Tubing insertion length (mm)	H ₁ Width across flat (mm)	H ₂ Width across flat (mm)	H ₃ Width across flat (mm)	C (mm)	d ₁ (mm)	D ₂ (mm)	Effective sectional area (mm ²)	Weight (g)
S1/4-FS1/4	S1/4	G1/4	123.3	5.7	18	14.0	14.0	19.0	7.0	5.0	11.2	18.5	55.0
S3/8-FS3/8	S3/8	G3/8	129.0	6.8	22	19.0	22.0	22.0	10.0	8.0	15.6	46.5	102.0
S1/2-FS1/2	S1/2	G1/2	189.0	9.5	29	24.0	27.0	27.0	14.0	10.2	19.8	80.0	193.0

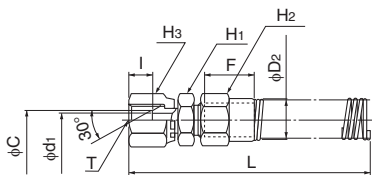

Nylon sleeve (dedicated for nylon coil tubing)

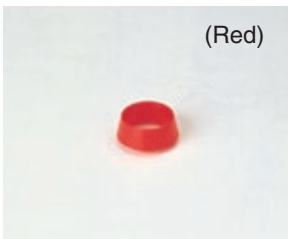

(Red)

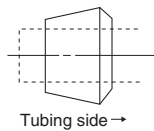

Caution
Pay attention to the directions when attaching the sleeve.

Product number	Applicable nylon coil tubing outer diameter
SS3/16	S3/16
SS1/4	S1/4
SS3/8	S3/8
SS1/2	S1/2

Caution: Nylon sleeves that have been used once cannot be reused.

Brass sleeve (dedicated for nylon coil tubing)



Product number	Applicable nylon coil tubing outer diameter
S1/3/4	S3/4

Caution: Nylon sleeves that have been used once cannot be reused.

Insertion part for S3/4



Product number	Applicable nylon coil tubing outer diameter
S1/3/4	S3/4

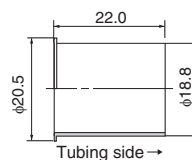

Tubing

Clean tubing

Processed tubing

PushOne fitting

QuickSeal fitting

Clean fitting/Chemifit

Bamboo-shoot fitting

Control switch/Detachable series

Jig/Tool/Accessory

Technical information

Reference