

# PushOne™ E Series Brass Body Type

PushOne™ fittings for general air pressure

## Features

- PushOne connection of tubing  
The tubes can be connected without using a jig or tools.
- Electrically conductive if combined with a UE tubing
- Flame-resistant resin (compliant with V-0 of UL94 standard)  
Made of flame-resistant resin PBT. High self-extinguishing performance is compliant with V-0 of UL94 standard. Usable under an environment with spatters.
- Sealing-processed R thread  
Sealing tape is not required.
- The tubing direction can be adjusted even after the thread is tightened for types such as elbow, tee, etc.



## Cross-sectional structure diagram

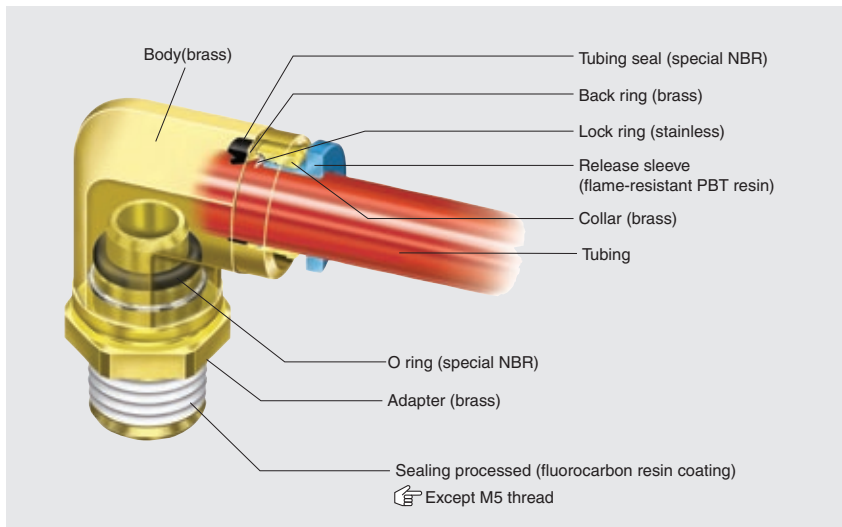

## Operating fluid, working temperature range

Operating fluid	Working temperature range
Air	-20°C~+80°C

See "Combination List of Tubing and Fitting" on page 8.

## Pressure condition

**Maximum working pressure:** 1.0MPa  
**Negative pressure performance:** -99.975kPa

## Handling instructions

- ⚠ Caution: When the working conditions of tubes and fittings differ, use them under the lower specified conditions.
  - ⚠ Caution: Do not bend the pipe sharply near the tubing insertion port of the fitting. Keep the tubing straight for twice as long as the tubing diameter from the insertion port.
- See page 34 for the common handling instructions for fittings.

## Product number example

**MEL 6 - PT1/8**

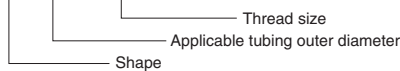

## Applicable tubing

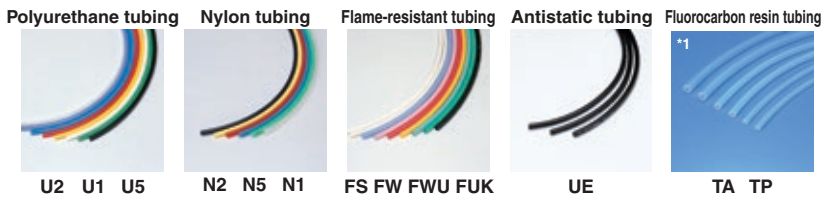

(\*1) Combinatory use of TA or TP tubing and PushOne E series of the Brass body type mixes general and clean type performances. When using them together in a clean environment, be aware of how this could lower the cleanliness level.

## Related products and product introduction

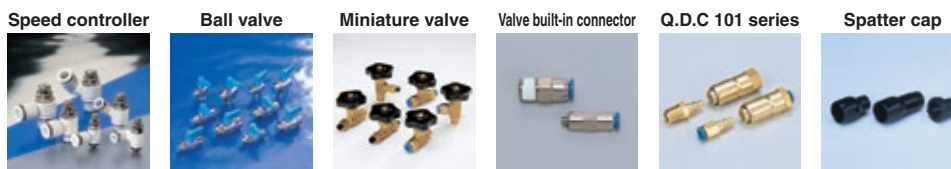

## Reference

Instruction manual .....P.170  
UL-94 standard flame test .....P.195  
Effective sectional area ..P.168  
Negative-pressure performance list .....P.169

Tubing  
Clean tubing  
Processed tubing  
PushOne fitting  
QuickSeal fitting  
Clean fitting/Chemifit  
Bamboo-shoot fitting  
Control switch/Detachable series  
Jig/Tool/Accessory  
Technical information  
Reference

# PushOne™E Series Brass Body Type

## Shape list

90 degree elbow  
MEL



Tee  
MET



Service tee  
MEST



Union connector  
MEUC



90 degree union elbow  
MEUL



Union tee  
MEUT



Blank plug  
BC



Nipple  
EN



☞ Choose a connector from the PushOne A or E series.

Tubing

Clean tubing

Processed tubing

PushOne fitting

QuickSeal fitting

Clean fitting/  
Chemifit

Bamboo-shoot fitting

Control switch/  
Detachable series

Jig/Tool/  
Accessory

Technical information

Reference

90 degree elbow

●Millimeter size type

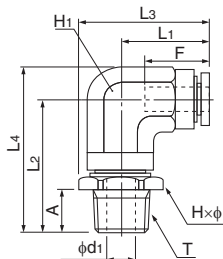

Product number	Applicable tubing outer diameter (mm)	T Thread size (R)	L1 (mm)	L2 (mm)	L3 (mm)	L4 (mm)	A (mm)	F Tubing insertion length (mm)	H×φ Width across flat (mm)	H1 Width across flat (mm)	d1 (mm)	Min. inner diameter (mm)	Effective sectional area (mm <sup>2</sup> )	Weight (g)
MEL4-PT1/8	4	R1/8	16.3	26.0	22.8	31.8	8.0	13	12.0×13.0	10.0	5.0	3.0	4.0	22.0
MEL4-PT1/4	4	R1/4	16.3	29.0	24.0	34.8	11.0	13	14.0×15.4	10.0	7.0	3.0	4.0	28.0
MEL6-PT1/8	6	R1/8	18.7	27.0	26.4	33.9	8.0	15	14.0×15.4	12.0	5.0	5.0	12.0	31.0
MEL6-PT1/4	6	R1/4	18.7	30.0	26.4	36.9	11.0	15	14.0×15.4	12.0	7.0	5.0	12.0	35.0
MEL8-PT1/8	8	R1/8	20.2	27.5	29.5	35.6	8.0	16	17.0×18.5	14.0	5.0	5.0	18.5	41.0
MEL8-PT1/4	8	R1/4	20.2	30.5	29.5	38.6	11.0	16	17.0×18.5	14.0	7.0	7.0	23.0	45.0
MEL8-PT3/8	8	R3/8	20.2	31.5	29.5	39.6	12.0	16	17.0×18.5	14.0	9.0	7.0	23.0	53.0
MEL10-PT1/8	10	R1/8	24.6	29.0	35.1	39.4	8.0	19	19.0×21.0	18.0	5.0	5.0	22.0	65.0
MEL10-PT1/4	10	R1/4	24.6	32.0	35.1	42.4	11.0	19	19.0×21.0	18.0	7.0	7.0	34.5	70.0
MEL10-PT3/8	10	R3/8	24.6	33.0	35.1	43.4	12.0	19	19.0×21.0	18.0	9.0	9.0	37.0	75.0
MEL10-PT1/2	10	R1/2	24.6	37.0	36.6	47.4	15.0	19	22.0×24.0	18.0	12.0	9.0	37.0	92.0
MEL12-PT1/4	12	R1/4	26.6	32.0	37.1	42.4	11.0	20	19.0×21.0	18.0	7.0	7.0	36.0	69.0
MEL12-PT3/8	12	R3/8	26.6	33.0	37.1	43.4	12.0	20	19.0×21.0	18.0	9.0	9.0	43.0	75.0
MEL12-PT1/2	12	R1/2	26.6	37.0	38.6	47.4	15.0	20	22.0×24.0	18.0	12.0	9.0	43.0	92.0

Tee

●Millimeter size type

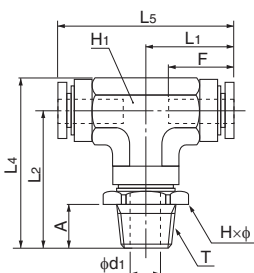

Product number	Applicable tubing outer diameter (mm)	T Thread size (R)	L1 (mm)	L2 (mm)	L4 (mm)	L5 (mm)	A (mm)	F Tubing insertion length (mm)	H×φ Width across flat (mm)	H1 Width across flat (mm)	d1 (mm)	Min. inner diameter (mm)	Effective sectional area (mm <sup>2</sup> )	Weight (g)
MET6-PT1/8	6	R1/8	18.7	27.0	33.9	37.3	8.0	15	14.0×15.4	12.0	5.0	5.0	12.0	35.0
MET6-PT1/4	6	R1/4	18.7	30.0	36.9	37.3	11.0	15	14.0×15.4	12.0	7.0	5.0	12.0	39.0
MET8-PT1/8	8	R1/8	20.2	27.5	35.6	40.4	8.0	16	17.0×18.5	14.0	5.0	5.0	18.5	46.0
MET8-PT1/4	8	R1/4	20.2	30.5	38.6	40.4	11.0	16	17.0×18.5	14.0	7.0	7.0	23.0	50.0
MET10-PT1/8	10	R1/8	24.6	29.0	39.4	49.1	8.0	19	19.0×21.0	18.0	5.0	5.0	22.0	80.0
MET10-PT1/4	10	R1/4	24.6	32.0	42.4	49.1	11.0	19	19.0×21.0	18.0	7.0	7.0	34.5	84.0
MET10-PT3/8	10	R3/8	24.6	33.0	43.4	49.1	12.0	19	19.0×21.0	18.0	9.0	9.0	37.0	90.0
MET10-PT1/2	10	R1/2	24.6	37.0	47.4	49.1	15.0	19	22.0×24.0	18.0	12.0	9.0	37.0	106.0
MET12-PT1/4	12	R1/4	26.6	32.0	42.4	53.2	11.0	20	19.0×21.0	18.0	7.0	7.0	36.0	86.0
MET12-PT3/8	12	R3/8	26.6	33.0	43.4	53.2	12.0	20	19.0×21.0	18.0	9.0	9.0	43.0	92.0
MET12-PT1/2	12	R1/2	26.6	37.0	47.4	53.2	15.0	20	22.0×24.0	18.0	12.0	9.0	43.0	108.0

Service tee

●Millimeter size type

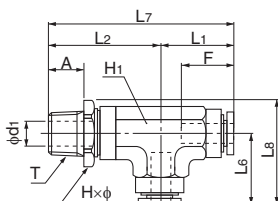

Product number	Applicable tubing outer diameter (mm)	T Thread size (R)	L1 (mm)	L2 (mm)	L6 (mm)	L7 (mm)	L8 (mm)	A (mm)	F Tubing insertion length (mm)	H×φ Width across flat (mm)	H1 Width across flat (mm)	d1 (mm)	Min. inner diameter (mm)	Effective sectional area (mm <sup>2</sup> )	Weight (g)
MEST6-PT1/8	6	R1/8	18.7	28.1	18.7	46.8	26.4	8.0	15	14.0×15.4	12.0	5.0	5.0	12.0	37.0
MEST6-PT1/4	6	R1/4	18.7	31.1	18.7	49.8	26.4	11.0	15	14.0×15.4	12.0	7.0	5.0	12.0	41.0
MEST8-PT1/8	8	R1/8	20.2	29.1	20.2	49.3	29.5	8.0	16	17.0×18.5	14.0	5.0	5.0	18.5	50.0
MEST8-PT1/4	8	R1/4	20.2	32.1	20.2	52.3	29.5	11.0	16	17.0×18.5	14.0	7.0	7.0	23.0	54.0
MEST10-PT1/8	10	R1/8	24.6	30.1	24.6	54.7	35.1	8.0	19	19.0×21.0	18.0	5.0	5.0	22.0	82.0
MEST10-PT1/4	10	R1/4	24.6	33.1	24.6	57.7	35.1	11.0	19	19.0×21.0	18.0	7.0	7.0	34.5	86.0
MEST10-PT3/8	10	R3/8	24.6	34.1	24.6	58.7	35.1	12.0	19	19.0×21.0	18.0	9.0	9.0	37.0	92.0
MEST10-PT1/2	10	R1/2	24.6	38.1	24.6	62.7	36.6	15.0	19	22.0×24.0	18.0	12.0	9.0	37.0	108.0
MEST12-PT1/4	12	R1/4	26.6	34.1	26.6	60.7	37.1	11.0	20	19.0×21.0	18.0	7.0	7.0	36.0	90.0
MEST12-PT3/8	12	R3/8	26.6	35.1	26.6	61.7	37.1	12.0	20	19.0×21.0	18.0	9.0	9.0	43.0	95.0
MEST12-PT1/2	12	R1/2	26.6	39.1	26.6	65.7	38.6	15.0	20	22.0×24.0	18.0	12.0	9.0	43.0	112.0

Tubing

Clean tubing

Processed tubing

PushOne fitting

QuickSeal fitting

Clean fitting/Chemifit

Bamboo-shoot fitting

Control switch/Detachable series

Jig/Tool/Accessory

Technical information

Reference

## Union connector

### ● Millimeter size type

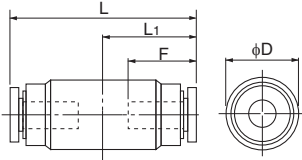

Product number	Applicable tubing outer diameter (mm)	L (mm)	L <sub>1</sub> (mm)	F Tubing insertion length (mm)	D (mm)	Min. inner diameter (mm)	Effective sectional area (mm <sup>2</sup> )	Weight (g)
MEUC6	6	31.5	15.8	15	14.0	5.0	12.5	20.0
MEUC8	8	32.6	16.3	16	16.0	7.0	28.0	27.0
MEUC10	10	39.5	19.8	19	19.0	9.0	45.0	49.0
MEUC12	12	41.4	20.7	20	21.0	11.0	67.0	52.0

## 90 degree union elbow

### ● Millimeter size type

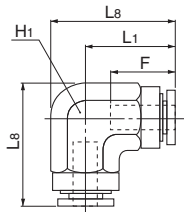

Product number	Applicable tubing outer diameter (mm)	L <sub>1</sub> (mm)	L <sub>8</sub> (mm)	F Tubing insertion length (mm)	H <sub>1</sub> Width across flat (mm)	Min. inner diameter (mm)	Effective sectional area (mm <sup>2</sup> )	Weight (g)
MEUL6	6	18.7	25.6	15	12.0	5.0	9.5	20.0
MEUL8	8	20.2	28.3	16	14.0	7.0	19.5	29.0
MEUL10	10	24.6	34.9	19	18.0	9.0	32.5	63.0
MEUL12	12	26.6	37.0	20	18.0	11.0	45.5	56.0

## Union tee

### ● Millimeter size type

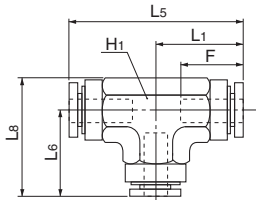

Product number	Applicable tubing outer diameter (mm)	L <sub>1</sub> (mm)	L <sub>5</sub> (mm)	L <sub>6</sub> (mm)	L <sub>8</sub> (mm)	F Tubing insertion length (mm)	H <sub>1</sub> Width across flat (mm)	Min. inner diameter (mm)	Effective sectional area (mm <sup>2</sup> )	Weight (g)
MEUT6	6	18.7	37.3	18.7	25.6	15	12.0	5.0	9.5	25.0
MEUT8	8	20.2	40.4	20.2	28.3	16	14.0	7.0	19.5	35.0
MEUT10	10	24.6	49.1	24.6	34.9	19	18.0	9.0	32.5	70.0
MEUT12	12	26.6	53.2	26.6	37.0	20	18.0	11.0	45.5	73.0

## Blank plug



☞ See the PushOne E series (P.71) for the product number and part sizes.

## Nipple



☞ See the PushOne E series (P.71) for the product number and part sizes.